

**Cycon™ Implant**

S-line is the best implant for narrow and tight ridges with a 3.0 mm diameter.

As we have two surfaces, our Bioactive's unique CaP hydrophilic surface and the SLA standard surface.

The implant S-Line eliminates the need for bone augmentation in narrow ridges.

S-line's connection with its screw is specifically designed to withstand a high fatigue point of 325Ncm.

S-line has a complete prosthetic collection such as CAD-CAM, Multi-Unit, and more.



[www.alfagate.com](http://www.alfagate.com)





**Maximum flexibility in rehabilitation:**  
Variety of prosthetic parts and components for single and multiple unit restorations.



**Soft tissue support :**  
Micro-ring for maximum alveolar bone volume.

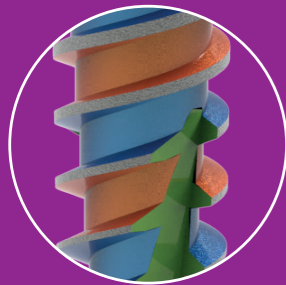

**High primary stability:**  
Sharp threads that change along the implant body allows for superior primary stability even in under-prepared osteotomies.

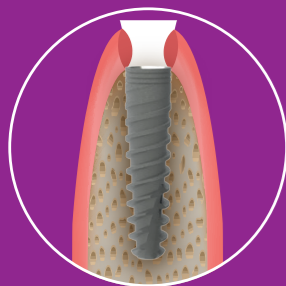

**Minimally invasive surgery:**  
Maximum bone preservation by the variable thread design enables self-drilling and self-tapping even in small osteotomies.

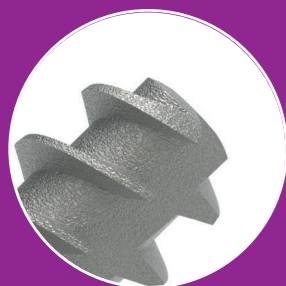

**Safe insertion:**  
Dome apex enables safe insertion.



## Diameters

<b>Material</b>	Titanium alloy ti 6Al 4V ELI   Bioactive Surface-Cap / SLA Surface
<b>Item includes</b>	Cover screw and implant carrier
<b>Description</b>	Screw type implant 2.0 mm Internal hex

Ø mm **3.0**

L mm **10 11.5 13 16**

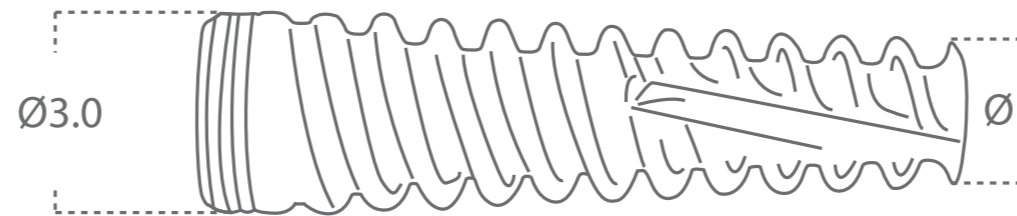
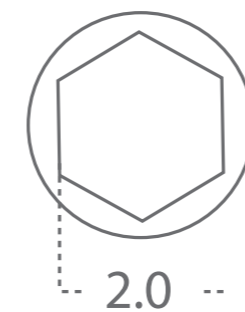

## Body Characteristics



Conical Body



Domed Apex



Micro-rings



Switching Platform



Internal Hex Connection with Conical Sealing Design



Variable Thread Design

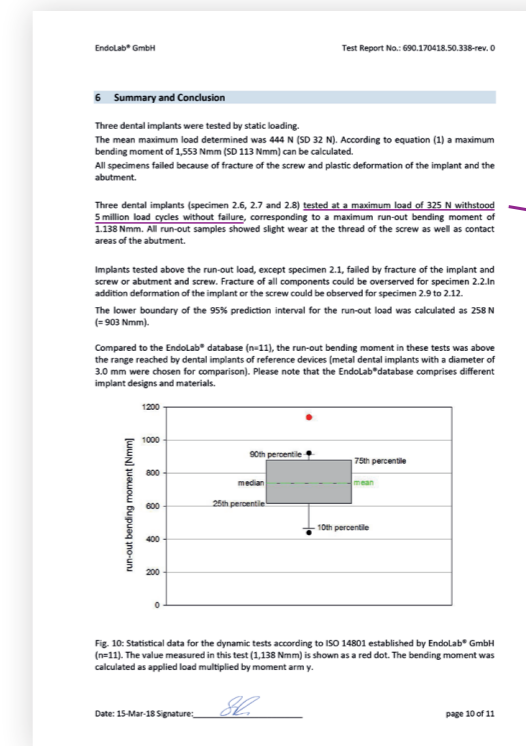

"...the run-out bending moment in these tests was above the range reached by dental implants of reference devices

With a maximum load of 325 N Sline implant withstood 5 million load cycles without failure, improving the long-term survival of the implant."

Small, but **STRONG!**

Screw maximum fatigue strength: **325 N**

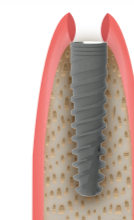

The ultimate implant for narrow and tight ridges.